

Sold

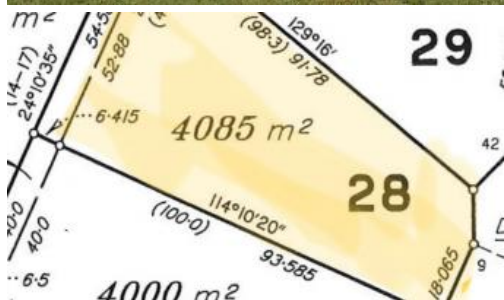

Atherton



ACRE IN ATHERTON

If your looking for a little space but still would like to be close to town, here is an acre on the edge of Atherton and only minutes to Main Street CBD.

Perfectly positioned in a great development, this 4085 square metre allotment has only recently become available and ready to build your dream home.

The property has bitumen road frontage, town water, on sewer and reasonably flat making it ideal for building.

Call now to secure this unique opportunity.

The above information provided has been furnished to us by the vendor/s. We have not verified whether or not that information is accurate and do not have any belief in one way or the other in its accuracy. We do not accept any responsibility to any person for its accuracy and do no more than pass it on. All interested parties should make and rely upon their own inquiries in order to determine whether or not this information is in fact accurate.

4,085 m²

| | |
|----------------------|----------------------|
| Price | SOLD |
| Property Type | Residential |
| Property ID | 342 |
| Land Area | 4,085 m ² |

AGENT DETAILS

Fred Barletta - 0419 714 483

OFFICE DETAILS

Atherton
P.O. BOX 711 Atherton QLD 4883
Australia
0419 714 483

